



DOW FILMTEC™ TW30-3012E-600 Element

Description

DOW FILMTEC™ Residential Reverse Osmosis (RO) Elements are some of the most reliable and consistent elements manufactured in the industry. Advanced membrane technology and precision manufacturing result in elements produced to tight, pre-defined specifications with consistent RO element performance. Dow's focus on manufacturing excellence is an essential measure to ensure OEM and brand owner customers develop and maintain their reputation for building world class, reliable water purifiers that produce water consumers can trust.

DOW FILMTEC™ TW30-3012E-600 Residential RO Elements offer high flow, reliable salt rejection, and long element life as expected for use in premium tankless purifier systems. The combination of FILMTEC™ patented membrane flat sheet technology and engineered element design is harnessed to achieve performance that enables improved design flexibility for premium tankless systems. A summary of the element features includes:

- Delivered without a brine seal, encapsulation-ready.
- Stable, reliable performance even when treating high hardness waters
- 3012 element size for space-saving, compact purifier designs
- NSF International safety certification
- Dry shipping for convenient handling and long shelf-life

Product Type

Spiral-wound element with polyamide thin-film composite membrane

Product Specifications

DOW FILMTEC™ Element	Applied Pressure		Permeate Flow Rate		Typical Stabilized Salt Rejection (%)
	(psig)	(bar)	(GPD)	(L/m)	
TW30-3012E-600	87	6.0	600	1.57	98

1. Permeate flow and salt rejection based on the following test conditions: 250 ppm NaCl, 77°F (25°C), pH 8.0, 40% recovery and the specified applied pressure.
2. Minimum salt rejection is 96.0%.
3. Permeate flows for individual elements may vary +25/-15%
4. Maximum feed flow 1.0 gpm (3.79 l/m)

Element Dimensions



COMPONENT

This component is Tested and Certified by NSF International against NSF/ANSI Standard 58 for material requirements only.

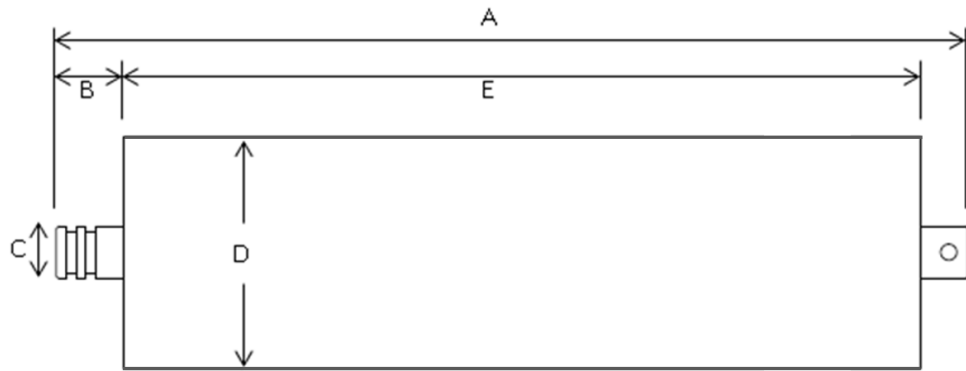

	A		B		C		D		E	
DOW FILMTEC™ Element	(in.)	(mm.)	(in.)	(mm)	(in.)	(mm)	(in.)	(mm)	(in.)	(mm)
TW30-3012E-600	11.74	298	0.875	22.2	0.68	17	2.95	74.9	10.25	260.4

Figure 1

Impact of Pressure on Target Permeate Flow (constant temperature, recovery)

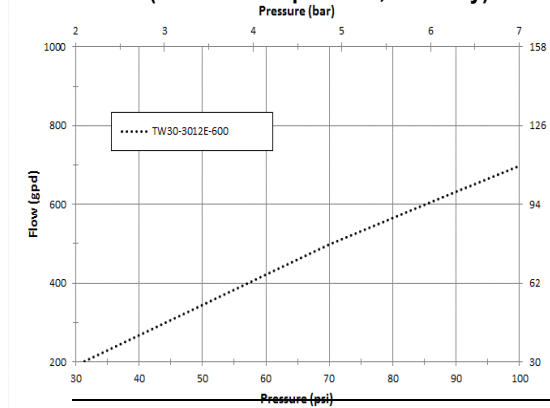
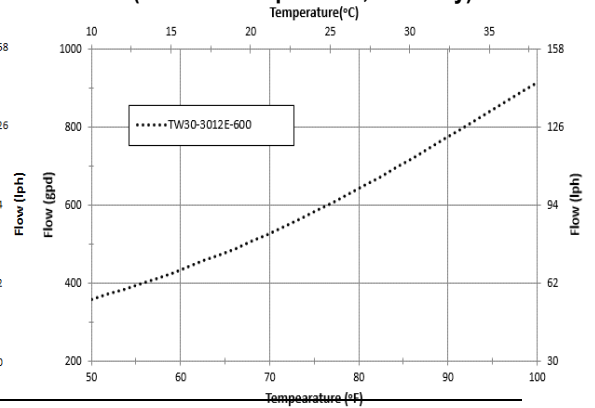

Figure 2

Impact of Temperature on Target Permeate Flow (constant temperature, recovery)



Operating and Cleaning Limits

Maximum Operating Temperature ^a	113°F (45°C)
Maximum Operating Pressure	150 psig (10 bar)
Maximum Feed Flow Rate	1.0 gpm (3.8 lpm)
pH Range, Continuous Operation	2 – 11
Maximum Feed Silt Density Index (SDI)	SDI 5
Free Chlorine Tolerance ^b	< 0.1 ppm

^a Maximum temperature for continuous operation above pH 10 is 95°F (35°C).

^b Under certain conditions, the presence of free chlorine and other oxidizing agents will cause premature membrane failure. Since oxidation damage is not covered under warranty, Dow Water & Process Solutions recommends removing residual free chlorine by pretreatment prior to membrane exposure. Please refer to technical bulletin 609-22010 for more information.

Additional Important Information

- Permeate water obtained from the first hour of use should be discarded to the drain.
- Keep elements moist at all times after initial wetting.
- To ease installation, it is recommended to use a lubricant safe for indirect water contact on all seals. Potential options include water, glycerin based lubricants, and Dow Corning MOLYKOTE™ 111 Lubricant.
- Rotate the element about a quarter turn to ease installation and removal of the element. Ensure good interface between the o-rings and brine seal with their connection surfaces.
- It is recommended that systems using these elements rinse the elements for 24 hours, prior to first use, to meet NSF/ANSI 58 Standard.
- The use of this product does not necessarily guarantee the removal of cysts and pathogens from water. Effective cyst and pathogen reduction is dependent on the operation and maintenance of the system.
- DOW FILMTEC™ Residential RO Elements may be covered under the DOW FILMTEC™ Residential Element Limited Warranty, 609-50318. Contact a Dow representative for more information.

If operating limits and guidelines given in this Product Information Bulletin are not strictly followed, the Limited Warranty will be null and void.

Storage

Refer to technical bulletin 609-02103 for further information.

Regulatory Note

These membranes may be subject to drinking water application restrictions in some countries; please check the application status before use and sale.

Product Stewardship

Dow has a fundamental concern for all who make, distribute, and use its products, and for the environment in which we live. This concern is the basis for our product stewardship philosophy by which we assess the safety, health, and environmental information on our products and then take appropriate steps to protect employee and public health and our environment. The success of our product stewardship program rests with each and every individual involved with Dow products—from the initial concept and research, to manufacture, use, sale, disposal, and recycle of each product.

Customer Notice

For more information, contact Customer Information Group:

North America: 1-800-447-4369
Latin America: +55-11-5184-8722
Europe, Africa, Middle East: +31-115-672-626
Asia Pacific: +86-21-3851-4988

www.dowwaterandprocess.com

NOTICE: No freedom from infringement of any patent owned by Dow or others is to be inferred. Because use conditions and applicable laws may differ from one location to another and may change with time, Customer is responsible for determining whether products and the information in this document are appropriate for Customer's use and for ensuring that Customer's workplace and disposal practices are in compliance with applicable laws and other government enactments. The product shown in this literature may not be available for sale and/or available in all geographies where Dow is represented. The claims made may not have been approved for use in all countries. Dow assumes no obligation or liability for the information in this document. References to "Dow" or the "Company" mean the Dow legal entity selling the products to Customer unless otherwise expressly noted. NO WARRANTIES ARE GIVEN; ALL IMPLIED WARRANTIES OF MERCHANTABILITY OR FITNESS FOR A PARTICULAR PURPOSE ARE EXPRESSLY EXCLUDED. All information set forth herein is for informational purposes only. This information is general information and may differ from that based on actual conditions. Please note that physical properties may vary depending on certain conditions and while operating conditions stated in this document are intended to lengthen product lifespan and/or improve product performance, it will ultimately depend on actual circumstances and is in no event a guarantee of achieving any specific results. Nothing in this document should be treated as a warranty by Dow.

